

GRC Rafter Stick is an innovative and multifunctional product that can be applied as a grid in both outdoor and indoor areas. It achieves this without compromising the aesthetic value it provides, one of its advantages being its double sided texture that extends to its thick edge.

Type	Thickness x Width x Length (mm)	Weight (Kg)	Area (m ²) per sheet	Application
Square plain	20 x 50 x 2400	4,2	0,12	Decorative
Square plain	20 x 100 x 2400	8,4	0,24	Decorative
Round plain	20 x 100 x 2400	8,2	0,24	Decorative
Square mahoni	20 x 50 x 3000	4,7	0,15	Decorative
Square mahoni	20 x 100 x 3000	9,4	0,30	Decorative
Round mahoni	20 x 100 x 3000	9,3	0,30	Decorative

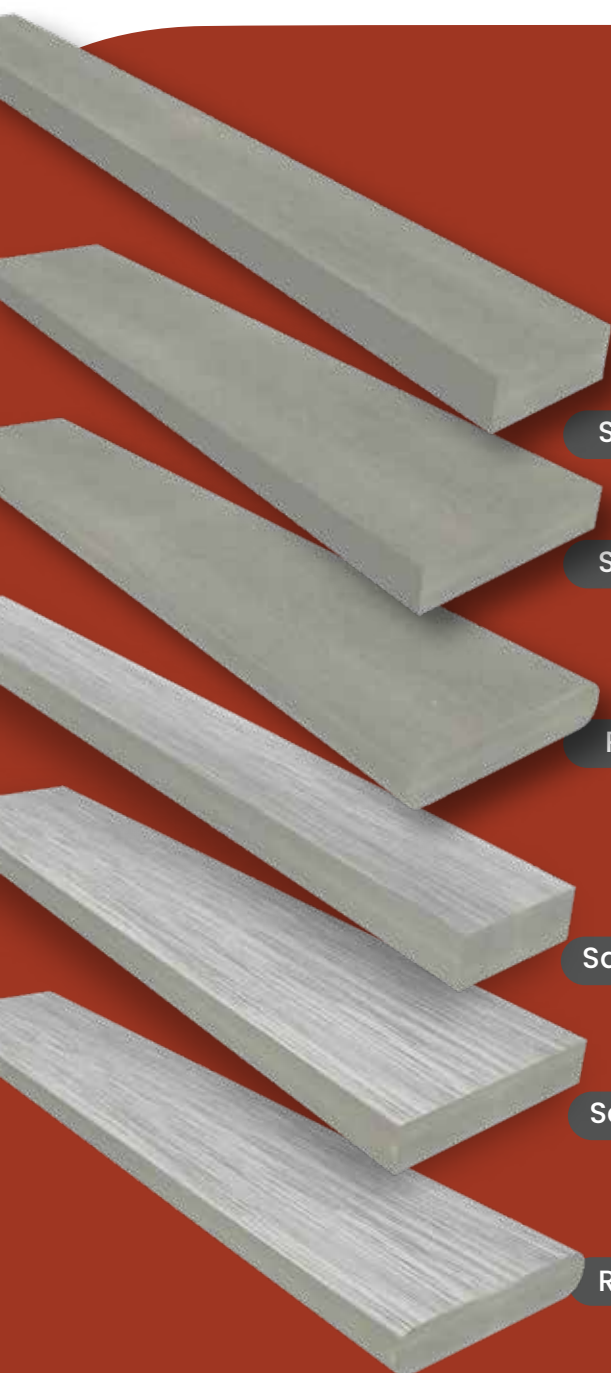

Square plain

Square plain

Round plain

Square mahoni

Square mahoni

Round mahoni



Double side mahoni texture



Double side texture





GRC Rafter Stick Installation Method

Application on the Frame

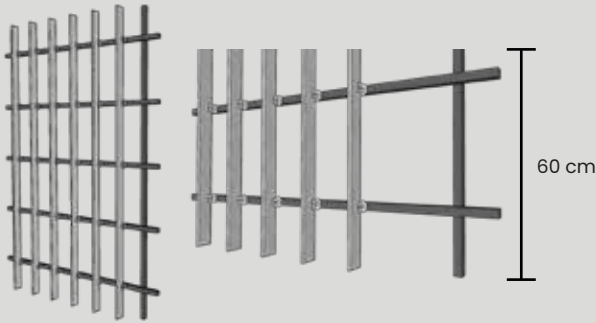

- Use a 40 cm×40 cm frame as the main frame. Maintain a maximum distance of 60 cm between horizontal frames for bracket placement, and a maximum distance of 60 cm between brackets.
- Use 10 mm hex bolts on the brackets to attach the GRC Rafter Stick.
- Paint using a special water-based paint for fiber cement, applying a base coat (primer) before painting.

Application on the Wall

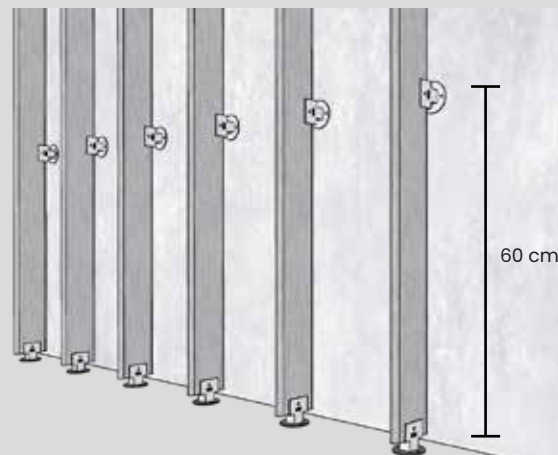
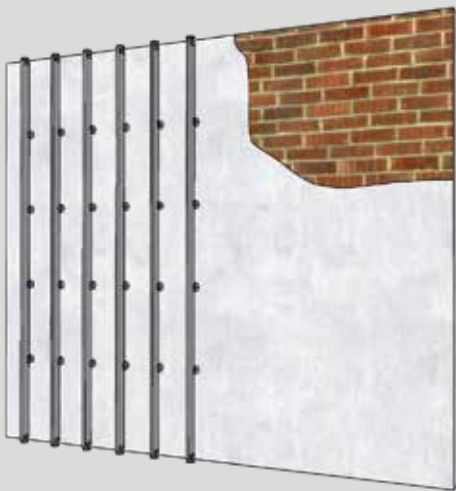

- Ensure that the wall surface is flat, smooth, and free of undulations (not wavy).
- Mark the screw points for the brackets and the location of the plastic plugs/anchors (fischers). Use a 3 mm concrete drill bit to pilot the holes. Then, drill the holes to a depth of 3 cm using a 6 mm concrete drill bit and insert the S6 plastic plug/anchor (fischer).
- The maximum distance between brackets is 60 cm.
- Use 10 mm hex bolts on the brackets to secure the GRC Rafter Stick.
- Apply a primer coat followed by the finish coat of the special water-based paint for fiber cement



Square plain

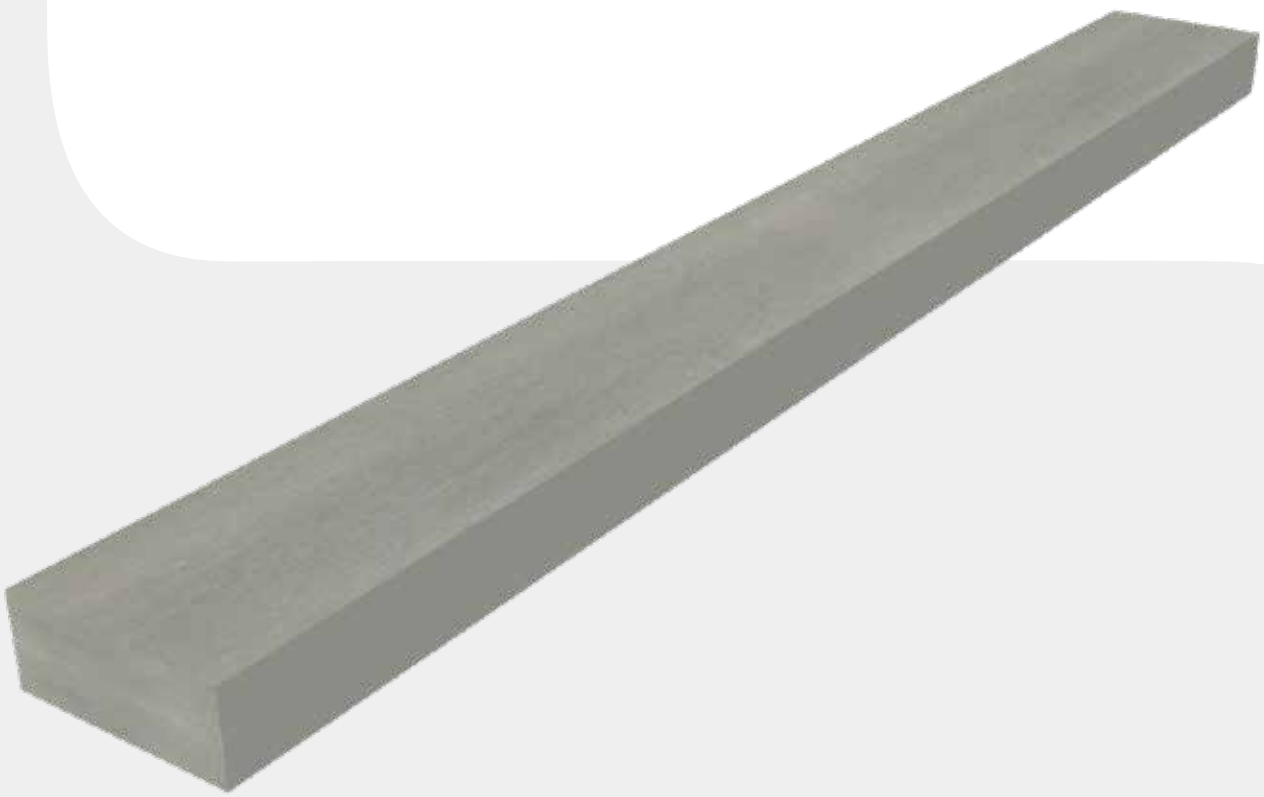



Square plain





Round plain

